

RECOMMENDED HANDGUARD INSTALLATION



1660 N. Rosemont STE 105
Mesa, AZ 85205

sales@gibbzarms.com

gibbzarms.com

shop.gibbzarms.com

facebook.com/GIBBZ.ARMS

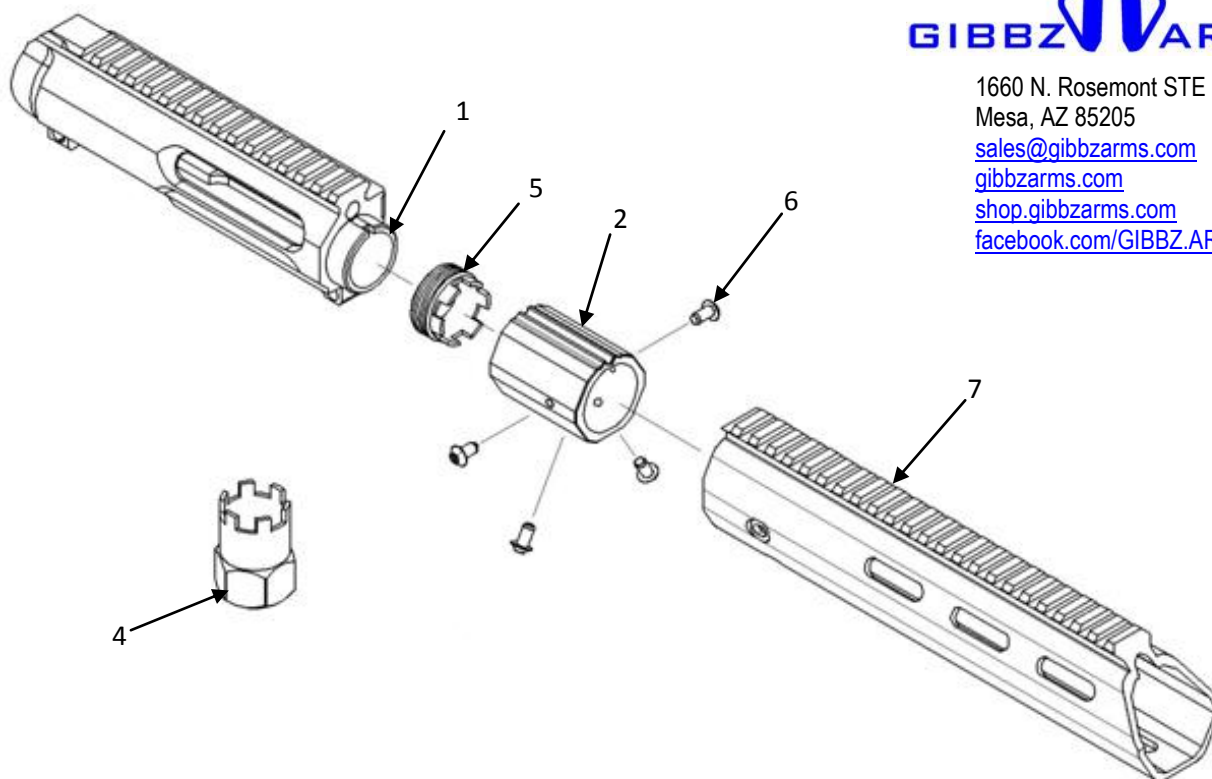

1. Apply Blue 243 Loctite™ to the threads of the Upper Receiver (1).
2. Insert Barrel and Barrel Extension assembly into the Upper Receiver making sure the alignment pin is in the slot of the Upper Receiver.
3. Ensure the Barrel Nut (5) is screwed fully into the Handguard Adapter then screw Handguard Adapter (2) on to the Upper Receiver(1) until it stops, then back it off only enough for the gas tube saddle on the Handguard Adapter to be lined up with the gas port on the Upper Receiver.
4. Slide the Handguard (7) on the Handguard Adapter (2) Line up the rails and clamp an accessory (like a sight or scope mount) on the rail bridging the gap between the upper and Handguard and tighten. Then screw in the Button Head Screws (6) and hand tighten them. Do not torque them to full torque value at this time.
5. Let the Loctite™ cure for 24 hours.
6. Remove the Button Head Screws (6), the accessory providing the alignment and Handguard (7).
7. Using the Installation Tool (4) snug the Barrel Nut, by using an adjustable wrench on the flats of the Handguard Adapter (2). Use the torque value of 45 ft.lbs. Do not over torque! Tape on the Handguard Adapter (2) will prevent marks.
8. Remove the Installation Tool.
9. Slide Handguard (7) onto the Handguard Adapter (2), sliding it all the way back until it touches the Upper Receiver. Then screw in the Button Head Screws (6) and torque to 16 - 20 in.lbs. Do not over torque!

INSTALLATION OF THE ACCESSORY RAIL.

1. Make sure the T-Nut is aligned with the bosses on the rail.
2. Insert the T-Nut and bosses into the desired vent hole.
3. Tighten the Button Head Screws and torque to 23 - 29 in.lbs. Do not over torque!

